

RIGHT SIDE
FRONT OF TRUCK

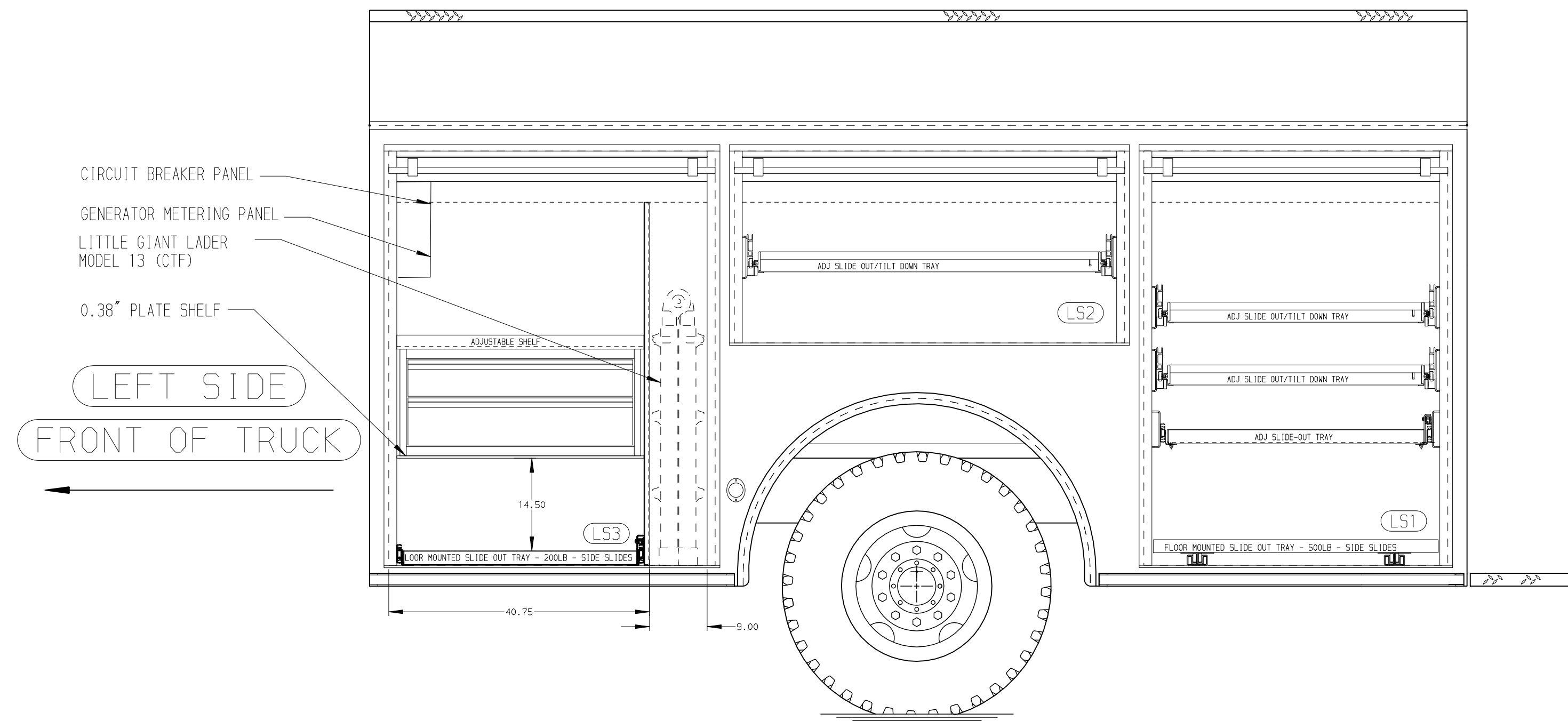

LEFT SIDE
FRONT OF TRUCK

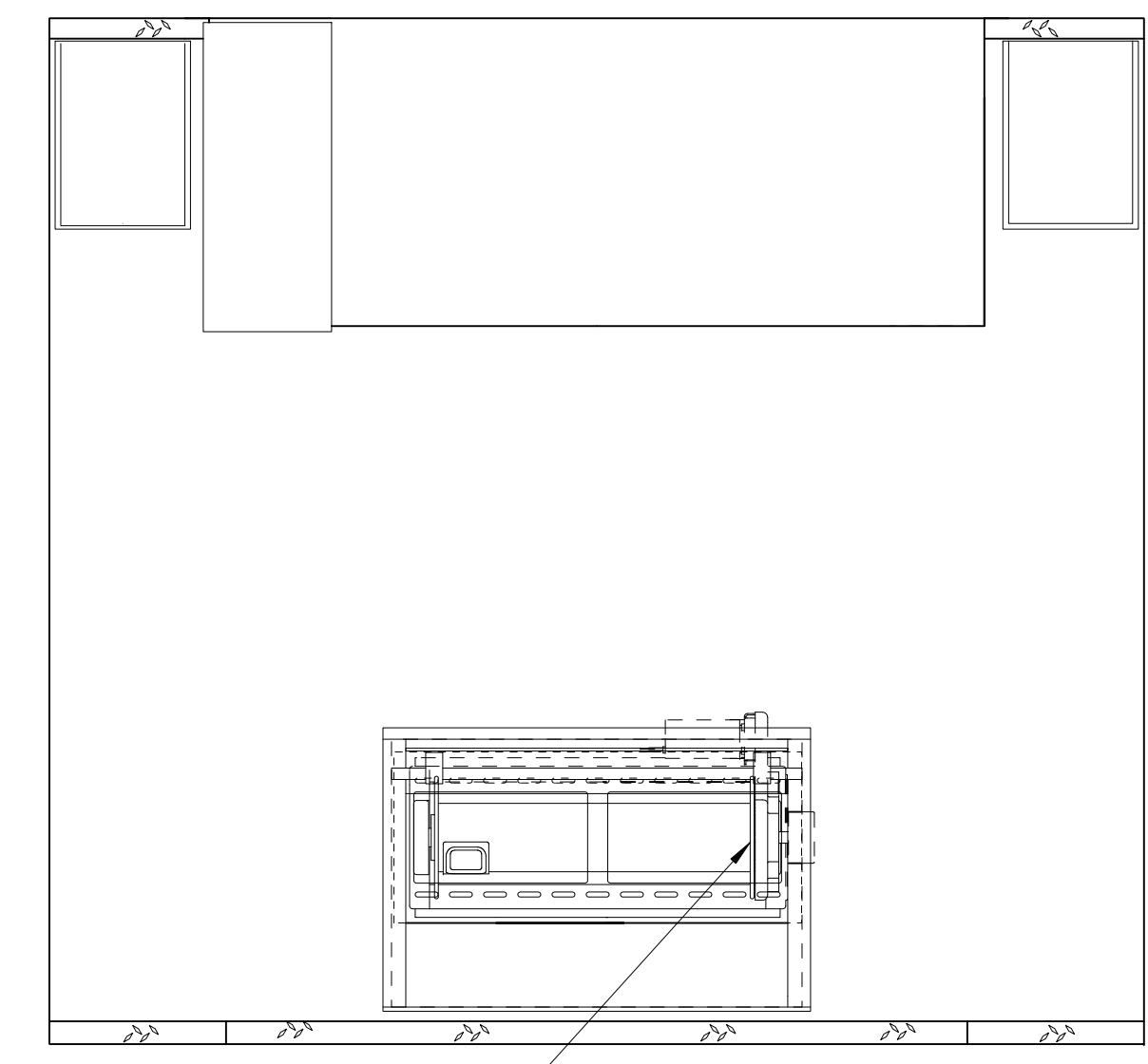

HANNAY ELECTRIC REWIND CORD REEL
MODEL ELFCR1636-10-11-6 WITH
175' OF 10/4 CORD

NOTE
DIMENSIONS SHOWN ARE APPROXIMATE
AND ARE SUBJECT TO MINOR DEVIATIONS
AS MAY OCCUR OR BE NECESSARY IN
CONSTRUCTION.
MINOR DETAILS NOT SHOWN.

1. ONE 5-SLOT AIR BAG RACK LOCATED PER ORDER
2. TWO 120V NEMA DUPLEX RECEPTACLES LOCATED PER ORDER

REV	DATE	BY	CH	ENFORCER
▽	19JAN24	KLE	-	MAKE
▽	17JAN24	KLE	CSH	PIERCE
▽	15JAN24	KLE	CSH	MODEL



TITLE	INFO DWG, COMPT INTERIOR, PUMPER ROLL-UP DOORS
FOR	LAGRANGE FIRE & RESCUE DEPARTMENT LAGRANGE, KENTUCKY
DWG NO.	38387AD-SH2

JOB NO.	38387
SCALE	1:16
DATE	09OCT23
DRAWN BY	LST
CHECKED BY	CDU
SHEET SIZE	D
SHEET NO.	2 OF 2